

# PV6 Series



Illuminated



Water Protection



Heavy Duty



Front Panel Mount

RoHS

NEW

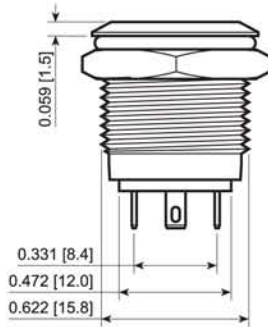
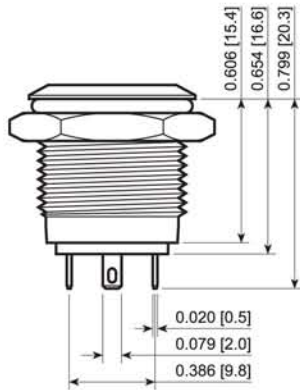
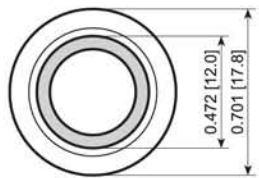

## Suggested Panel Cutout

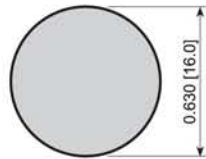

Maximum Panel Thickness 0.394 [10.0mm]

## Illumination Options

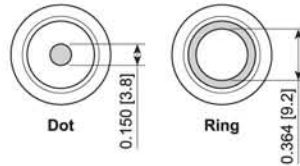

## FEATURES:

- Vandal and Water Resistant
- Long Life Expectancy

## SPECIFICATIONS:

**RATING:** 2A 48VDC  
**ILLUMINATION BASE RATING:**  
 Red, Yellow, and Orange: 20mA 1.8V  
 Blue, Green, and White: 20mA 2.8V  
**TEMPERATURE:** -20°C to 55°C  
**CONTACT RESISTANCE:** 50mΩ Max.  
**INSULATION RESISTANCE:** 1,000MΩ Min.  
**DIELECTRIC STRENGTH:** 2,000VAC  
**MECHANICAL LIFE:** 1,000,000 Cycles  
**ELECTRICAL LIFE:** 50,000 Cycles

## MATERIALS:

**BUTTON:** Stainless Steel  
 Nickel Plated Brass  
**BODY:** Stainless Steel  
 Nickel Plated Brass  
**BASE:** PBT

ANTI-VANDAL



PV6F240SS-341

Series	Actuator Options	Terminal	Function	Rating	Body Finish	Actuator Finish	Contact Material	Lens Style	Lens Color	Illumination Voltage
PV6	F - Flat	2 - Solder	4 - Off-(On)	0 - 2A 48VDC	N - Nickel S - Stainless Steel	N - Nickel S - Stainless Steel	None - Silver G - Gold	2 - Dot 3 - Ring	0 - White 1 - Red 2 - Orange 3 - Green 4 - Blue 5 - Yellow	1 - Base Voltage

## EXAMPLE PART NUMBERS:

**PV6F240SS-221** 1P Off-(On)  
*Flat Actuator, Orange Dot Illumination*  
**PV6F240SS-331** 1P Off-(On)  
*Flat Actuator, Green Ring Illumination*  
**PV6F240SS-341** 1P Off-(On)  
*Flat Actuator, Blue Ring Illumination*



E-SWITCH®

www.e-switch.com

800.867.2717

SPECIFICATIONS SUBJECT TO CHANGE WITHOUT NOTICE